

RECOMMENDED
ACCESS OPENING SPECIFICATION

- A TYPICAL ACCESS OPENING FOR THE STORMTRAP SYSTEM ARE 2'-0" IN DIAMETER. ACCESS OPENINGS LARGER THAN 3'-0" IN DIAMETER NEED TO BE APPROVED BY STORMTRAP. ALL OPENINGS MUST RETAIN AT LEAST 1'-0" OF CLEARANCE FROM THE END OF THE STORMTRAP MODULE UNLESS NOTED OTHERWISE. ALL ACCESS OPENINGS TO BE LOCATED ON INSIDE LEG UNLESS OTHERWISE SPECIFIED.
- PLASTIC COATED STEEL STEPS PRODUCED BY M.A. INDUSTRIES PART #P33-PFC OR APPROVED EQUAL (SEE STEP DETAIL) ARE PROVIDED INSIDE ANY MODULE WHERE DEEMED NECESSARY. THE HIGHEST STEP IN THE MODULE IS TO BE PLACED A DISTANCE OF 1'-0" FROM THE INSIDE EDGE OF THE STORMTRAP MODULES. ALL ENSURING STEPS SHALL BE PLACED WITH A MAXIMUM DISTANCE OF 1'-4" BETWEEN THEM. STEPS MAY BE MOVED OR ALTERED TO AVOID OPENINGS OR OTHER IRREGULARITIES IN THE MODULE.
- STORMTRAP LIFTING INSERTS MAY BE RELOCATED TO AVOID INTERFERENCE WITH ACCESS OPENINGS OR THE CENTER OF GRAVITY OF THE MODULE AS NEEDED.
- STORMTRAP ACCESS OPENINGS MAY BE RELOCATED TO AVOID INTERFERENCE WITH INLET AND/OR OUTLET PIPE OPENINGS SO PLACEMENT OF STEPS IS ATTAINABLE.
- ACCESS OPENINGS SHOULD BE LOCATED IN ORDER TO MEET THE APPROPRIATE MUNICIPAL REQUIREMENTS. STORMTRAP RECOMMENDS AT LEAST TWO ACCESS OPENINGS PER SYSTEM FOR ACCESS AND INSPECTION.
- USE PRECAST ADJUSTING RINGS AS NEEDED TO MEET GRADE. STORMTRAP RECOMMENDS FOR COVER OVER 2' TO USE PRECAST BARREL OR CONE INSPECTIONS. (PROVIDED BY OTHERS)

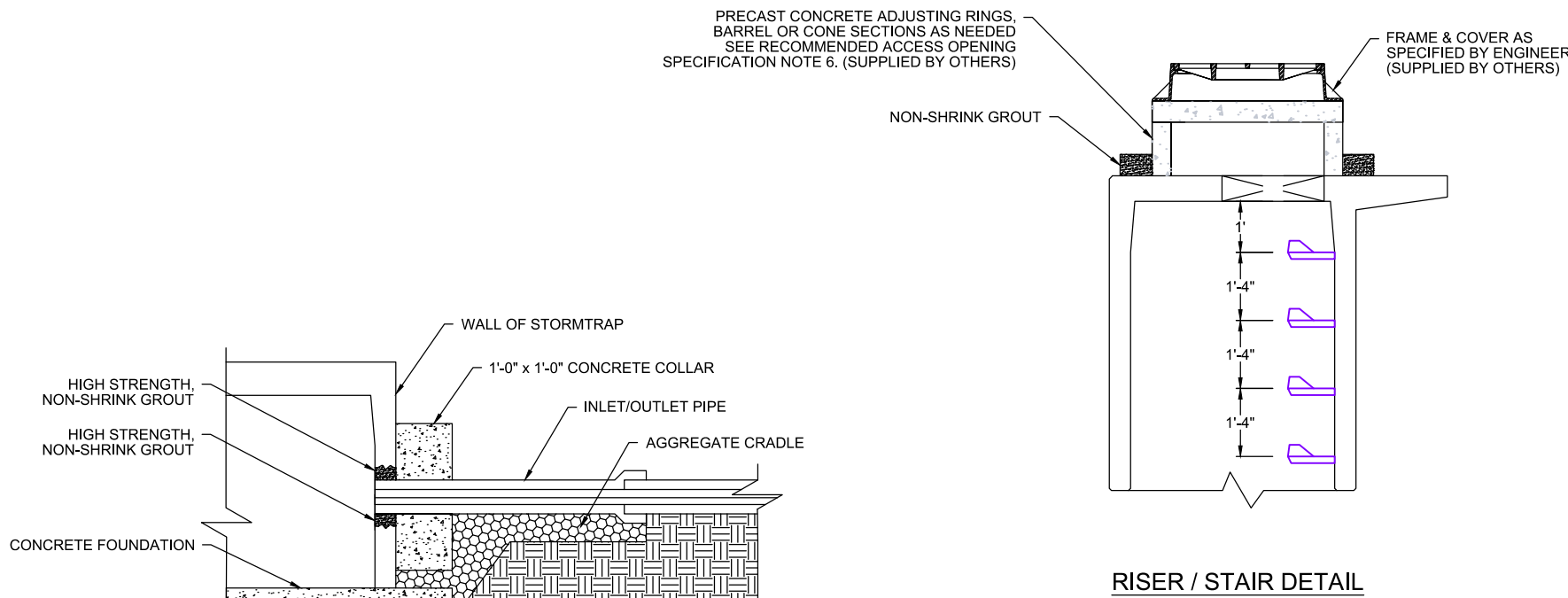

RECOMMENDED
PIPE OPENING SPECIFICATION

- MINIMUM EDGE DISTANCE FOR AN OPENING ON THE OUTSIDE WALL SHALL BE NO LESS THAN 1'-0".
- MAXIMUM OPENING SIZE TO BE DETERMINED BY THE MODULE HEIGHT. PREFERRED OPENING SIZE Ø 36" OR LESS. ANY OPENING NEEDED THAT DOES NOT FIT THIS CRITERIA SHALL BE BROUGHT TO THE ATTENTION OF STORMTRAP FOR REVIEW.
- CONNECTING PIPES SHALL BE INSTALLED WITH A 1'-0" CONCRETE COLLAR, AND AN AGGREGATE CRADLE FOR AT LEAST ONE PIPE LENGTH (SEE PIPE CONNECTION DETAIL). A STRUCTURAL GRADE CONCRETE OR HIGH STRENGTH, NON-SHRINK GROUT WITH A MINIMUM 28 DAY COMPRESSIVE STRENGTH OF 3000 PSI SHALL BE USED.
- THE ANNULAR SPACE BETWEEN THE PIPE AND THE HOLE SHALL BE FILLED WITH HIGH STRENGTH NON-SHRINK GROUT.

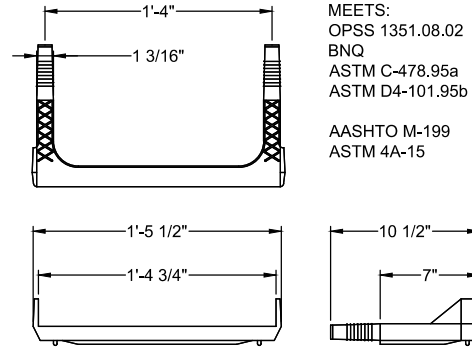
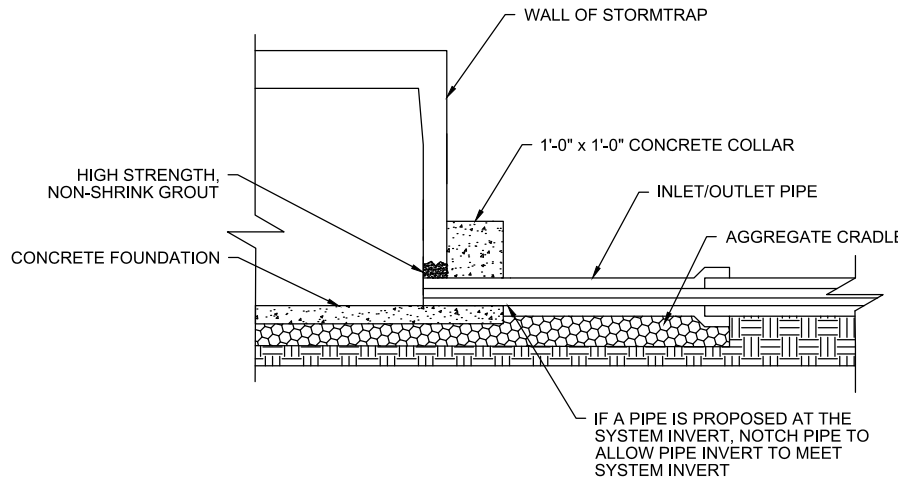

RECOMMENDED PIPE
INSTALLATION INSTRUCTIONS

- CLEAN AND LIGHTLY LUBRICATE ALL OF THE PIPE TO BE INSERTED INTO STORMTRAP.
- IF PIPE IS CUT, CARE SHOULD BE TAKEN TO ALLOW NO SHARP EDGES, BEVEL AND LUBRICATE LEAD END OF PIPE.
- ALIGN CENTER OF PIPE TO CORRECT ELEVATION AND INSERT INTO OPENING.

NOTE: ALL ANCILLARY PRODUCTS/SPECIFICATIONS RECOMMENDED AND SHOWN ON THIS SHEET ARE RECOMMENDATIONS ONLY AND SUBJECT TO CHANGE PER THE INSTALLING CONTRACTOR AND/OR PER LOCAL MUNICIPAL CODE/REQUIREMENTS.

PIPE CONNECTION DETAIL

STEP DETAIL

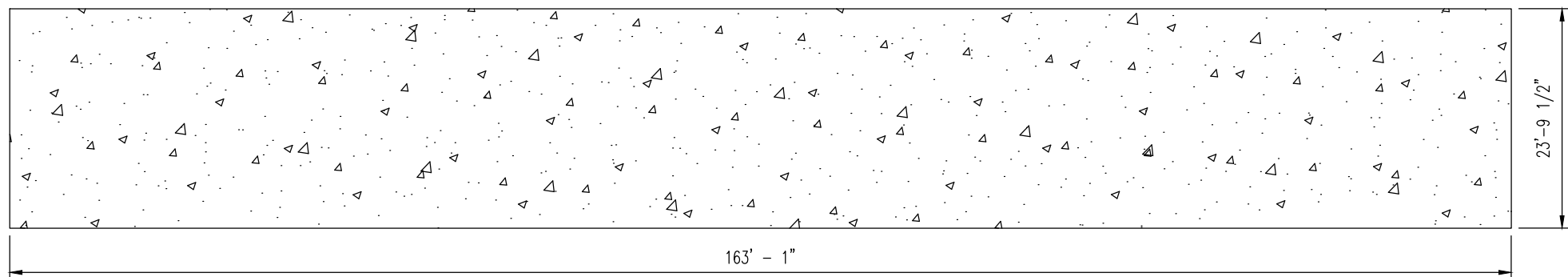

NOTES:

- CONCRETE STRENGTH @ 28 DAYS, 25-4% ENTRAINMENT AIR, 4" MAX. SLUMP.
- NET ALLOWABLE SOIL PRESSURE AS INDICATED ON SHEET 1.5.
- SOIL CONDITIONS TO BE VERIFIED ON SITE BY OTHERS.
- REBAR: ASTM A418 GRADE 60, BLACK BAR.
- DIMENSION OF FOUNDATION MUST HAVE 1'-0" OVERHANG BEYOND EXTERNAL FACE OF MODULE.
- DIMENSION OF STORMTRAP SYSTEM ALLOW FOR A 3/4" GAP BETWEEN EACH MODULE.
- ALL DIMENSIONS TO BE VERIFIED IN THE FIELD BY OTHERS.
- THE CONTROL JOINTS SHALL BE BETWEEN (IF REQUIRED BY ENGINEER OF RECORD) 16'-0" TO 24'-0" MAX APART.
- SEE SHEET 3.0 FOR INSTALLATION SPECIFICATIONS.

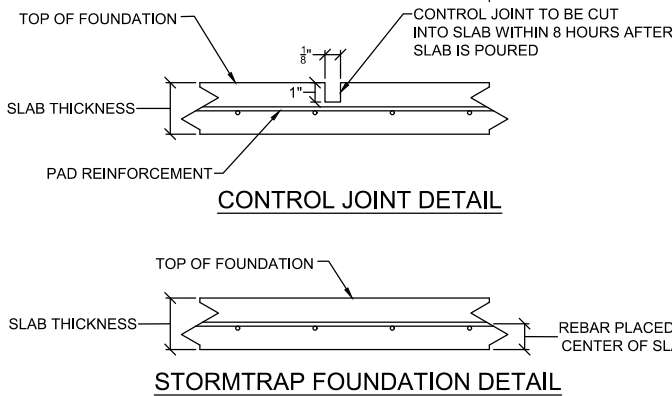

STORMTRAP FOUNDATION DETAIL

DESIGN CRITERIA

ALLOWABLE MAX GRADE = 206.08
ALLOWABLE MIN GRADE = 200.88
INSIDE HEIGHT ELEVATION = 199.58
SYSTEM INVERT = 197.08
STORMTRAP VOLUME = 7,603.50 C.F.

NOTES:

- DIMENSIONING OF STORMTRAP SYSTEM SHOWN BELOW ALLOW FOR A 3/4" GAP BETWEEN EACH MODULE.
- ALL DIMENSIONS TO BE VERIFIED IN THE FIELD BY OTHERS.
- SEE SHEET 3.0 FOR INSTALLATION SPECIFICATIONS.
- SP - INDICATES A MODULE WITH MODIFICATIONS.
- P - INDICATES A MODULE WITH A PANEL ATTACHMENT.
- CONTRACTORS RESPONSIBILITY TO ENSURE CONSISTENCY/ACCURACY TO FINAL ENGINEER OF RECORD PLAN SET.

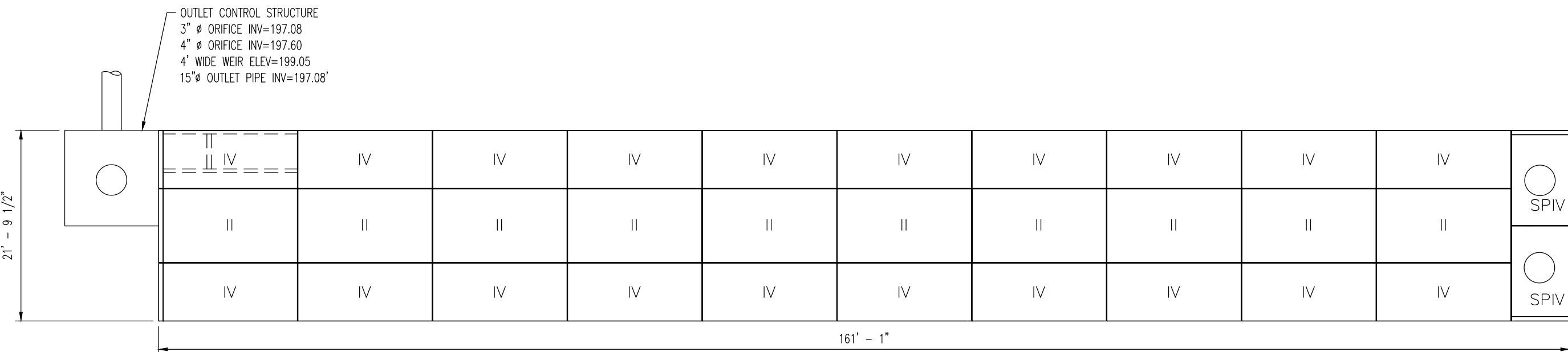

UNDERGROUND BASIN DETAILS

N.T.S.

SITE SPECIFIC DESIGN CRITERIA

- STORMTRAP UNITS SHALL BE MANUFACTURED AND INSTALLED ACCORDING TO SHOP DRAWINGS APPROVED BY THE INSTALLING CONTRACTOR AND ENGINEER OF RECORD. THE SHOP DRAWINGS SHALL INDICATE SIZE AND LOCATION OF ROOF OPENINGS AND INLET/ OUTLET PIPE TYPES, SIZES, INVERT ELEVATIONS AND SIZE OF OPENINGS.
- COVER RANGE: MIN. 0.80' MAX. 6.00' CONSULT STORMTRAP FOR ADDITIONAL COVER OPTIONS.
- ALL DIMENSIONS AND SOIL CONDITIONS, INCLUDING BUT NOT LIMITED TO GROUNDWATER AND SOIL BEARING CAPACITY ARE REQUIRED TO BE VERIFIED IN THE FIELD BY OTHERS PRIOR TO STORMTRAP INSTALLATION.
- FOR STRUCTURAL CALCULATIONS THE GROUND WATER TABLE IS ASSUMED TO BE BELOW INVERT OF SYSTEM IF WATER TABLE IS DIFFERENT THAN ASSUMED, CONTACT STORMTRAP.

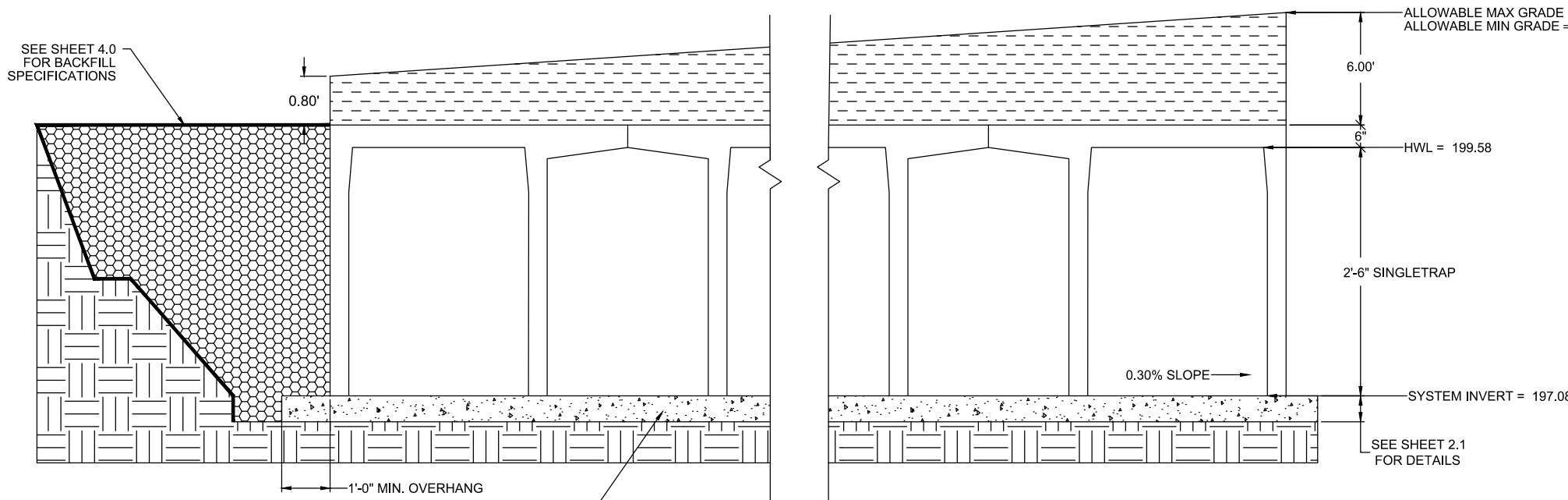

2'-6" SINGLETRAP

TYPE II

TYPE IV

TYPE II
END PANEL

TYPE IV
END PANEL

THIS PLAN SET IS FOR PERMITTING PURPOSES ONLY AND MAY NOT BE USED FOR CONSTRUCTION

DYNAMIC ENGINEERING LAND DEVELOPMENT CONSULTING • PERMITTING • GEOTECHNICAL • ENVIRONMENTAL • SURVEY • PLANNING & ZONING 1904 Main Street, Suite 110, Chester, NJ 07930 T: 908.879.9229 F: 908.879.0222 www.dynamicoc.com		245 Main Street, Suite 110 Chester, NJ 07930 T: 908.879.9229 F: 908.879.0222 www.dynamicoc.com
TITLE: CONSTRUCTION DETAILS		
PROJECT: CAPODAGLI PROPERTY COMPANY, LLC / MERIDIA, LLC MERIDIA VILLAGE COMMONS - PROPOSED MIXED-USE BUILDING	DRAWN BY: GH	DATE: 06/19/2017
BLOCK: 2303, LOTS 7-11 4TH STREET & VALLEY STREET (C.R. 638) TOWNSHIP OF SOUTH ORANGE VILLAGE, ESSEX COUNTY, NJ	DESIGNED BY: RJC	SCALE: (H) AS SHOWN
CHECKED BY: JCS	SHEET No: 11	
PROFESSIONAL ENGINEER NEW JERSEY LICENSE No. 47204 PENNSYLVANIA LICENSE No. 78935 ILLINOIS LICENSE No. 1-022 COLORADO LICENSE No. 34848 VIRGINIA LICENSE No. 01627	PROFESSIONAL ENGINEER NEW JERSEY LICENSE No. 41895 PENNSYLVANIA LICENSE No. 77727 NEW YORK LICENSE No. 087962 CONNECTICUT LICENSE No. 0027591	DEC Client Code: 1084 Rev. # 0